



BLUE-MASTER[®]
by *celesa*



DRILL CHUCKS

INDUSTRIAL CHUCKS FOR COLUMN OR CNC DRILLING MACHINE

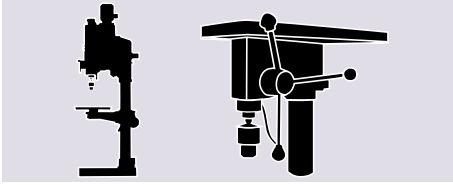

PREC.
<0,05

Ref. DC1

HIGH PRECISION

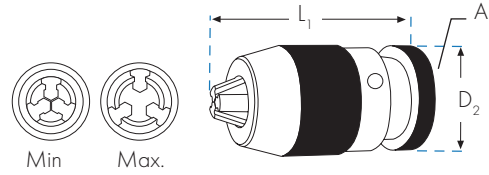

DC1						
	PRECISION mm	Min.-Max. mm	A	D2 mm	L1 mm	€
DC1-20-B22	<0,05	5-20	B22	58	130	206,12

PREC.
<0,20

Ref. DC3

INDUSTRIAL
LIGHT-WEIGHT

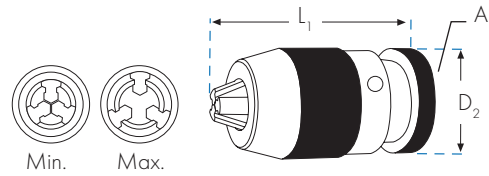

DC3						
	PRECISION mm	Min.-Max. mm	A	D2 mm	L1 mm	€
DC3-13-B16	<0,20	1-13	B16	43	94	81,90
DC3-13-3/8	<0,20	1-13	3/8-24 UNF	43	94	81,90
DC3-13-1/2	<0,20	1-13	1/2-20 UNF	43	94	81,90
DC3-16-B16	<0,20	1-16	B16	48	119	127,11
DC3-16-B18	<0,20	1-16	B18	48	119	127,11

INDUSTRIAL TAPER SHANK CHUCKS FOR COLUMN OR CNC DRILLING MACHINE

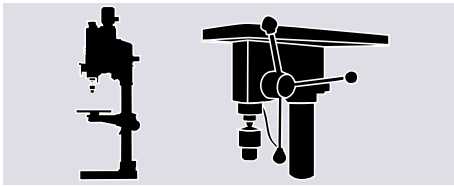

PREC. <0,05 Ref. DC10 **HIGH PRECISION**

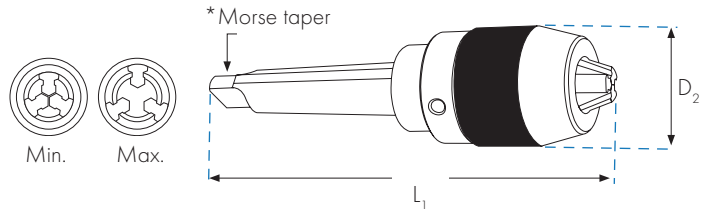

DC10						
	PRECISION mm	Min.-Max. mm	MT*	D ₂ mm	L ₁ mm	€
DC10-13-CM3	<0,05	1-13	MT3	51	192	264,23
DC10-13-CM4	<0,05	1-13	MT4	51	218	266,79
DC10-16-CM3	<0,05	1-16	MT3	56	207	270,16

PREC. <0,12 Ref. DC11 **INDUSTRIAL**

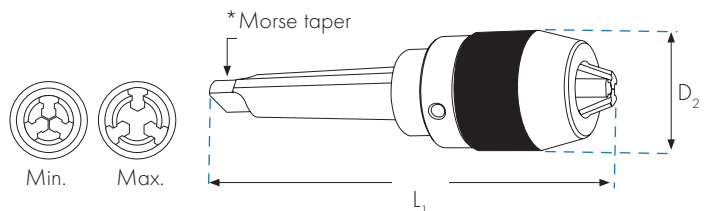

DC11						
	PRECISION mm	Min.-Max. mm	MT*	D ₂ mm	L ₁ mm	€
DC11-13-CM2	<0,12	1-13	MT2	51	174	159,55
DC11-13-CM3	<0,12	1-13	MT3	51	192	159,55
DC11-13-CM4	<0,12	1-13	MT4	51	218	159,55
DC11-16-CM3	<0,12	1-16	MT3	56	207	187,07

PIVOT KEY FOR DC11 DRILL CHUCK



NEW

DC20				
	Min.-Max. mm	D ₂ mm	L ₁ mm	€
DC20-1	1-13	4-5	180	11,59
DC20-2	1-16	4-5	190	13,65

PROFESSIONAL AUTO-LOCK DRILL CHUCKS

<950W

Ref. DC4



- Auto-lock
- Plastic sleeve.
- Rotary and hammer mode drilling.

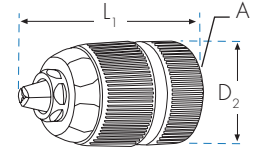
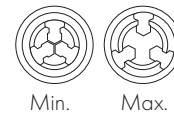

						DC4
	W	Min.-Max. mm	A	D2 mm	L1 mm	€
DC4-13-1/2	<950	1,5-13	1/2-20 UNF	43	75	37,98
DC4-13-1/2-SDS	<950	1,5-13	1/2-20 UNF	43	75	43,81

Ref. DC4-13-1/2-SDS

<1050W

Ref. DC5



- Auto-lock
- Metal sleeve
- High power
- Special jaws
- Rotary and hammer mode drilling.

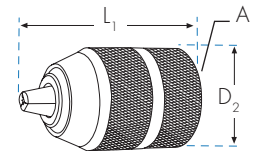
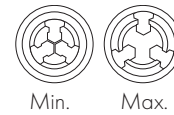

						DC5
	W	Min.-Max. mm	A	D2 mm	L1 mm	€
DC5-13-1/2	<1050	1,5-13	1/2-20 UNF	43	75	50,09
DC5-13-SDS	<1050	1,5-13	1/2-20 UNF	43	75	57,86

Ref. DC5-13-SDS

<950W

Ref. DC13



- Locking by tightening softly the drill chuck with the hand while spinning
- Designed for light power drill
- Plastic sleeve.



						DC13
	W	Min.-Max. mm	A	D2 mm	L1 mm	€
DC13-10-1/2	<950W	0,8-10	1/2-20 UNF	40	65	12,75

Ref. DC13-10-1/2

PROFESSIONAL KEY CHUCKS



Ref. DC6

- Rotary and hammer mode drilling.
- Key included.

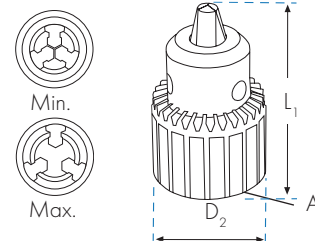

					DC6
	Min.-Max. mm	A	D2 mm	L1 mm	€
DC6-06-B10	0,5-6,5	B10	31	50	38,09
DC6-06-3/8	0,5-6,5	3/8-24 UNF	31	50	38,09
DC6-10-1/2	1-10	1/2-20 UNF	37	60	29,83
DC6-13-B12	1-13	B12	46	78	39,01
DC6-13-3/8	1-13	3/8-24 UNF	46	78	39,01
DC6-16-B16	1-16	B16	57	95	43,60
DC6-19-B22	5-20	B22	68	115	59,66

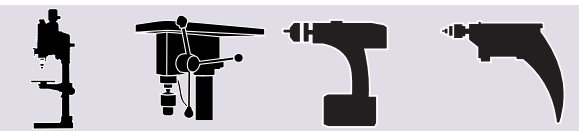

Ref. DC7

- Rotary and hammer mode drilling.
- Key included.

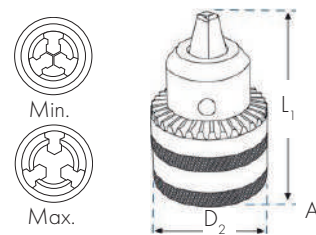

Ref. DC7-13-SDS

					DC7
	Min.-Max. mm	A	D2 mm	L1 mm	€
DC7-06-B10	0,6-6,5	B10	30	50	16,36
DC7-06-3/8	0,6-6,5	3/8-24 UNF	30	50	16,36
DC7-10-1/2	1,5-10	1/2-20 UNF	33	59	15,00
DC7-13-B12	1,5-13	B12	42	70	19,00
DC7-13-B16	1,5-13	B16	42	70	19,00
DC7-13-3/8	1,5-13	3/8-24 UNF	42	70	19,00
DC7-13-1/2	1,5-13	1/2-20 UNF	42	70	19,00
DC7-13-SDS	1,5-13	1/2-20 UNF	42	70	19,99
DC7-16-1/2	3-16	1/2-20 UNF	51	87	24,00

• For spare keys look at page 124.

DRILL CHUCK WITH FLEXIBLE EXTENSION

Ref. DC15-001

- 1050 mm length flexible extension
- Ø 1 to 6 mm auto-lock drill chuck.
- Max working speed: 6000 rpm.



DC15-001				
	Min.-Max. mm	D2 mm	L1 mm	€
DC15-001	1-6	30	1050	35,15

90° ANGLE DRILL CHUCK

Ref. DC15-002

- For areas with limited access.
- Drill always in rotary mode.
- Ø 1 to 10 mm auto-lock drill chuck.
- Lightweight. For left or right-handed drilling.



DC15-002				
	Min.-Max. mm	D2 mm	α	€
DC15-002	1-10	41	90°	20,58

HEX. SHANK MINI DRILL CHUCK



P29

- 1/4 Hex. Shank
- From 0,6 to 6,0 mm

18,48

PROFESSIONAL DRILL STAND

- Auto return feeding handle (it comes back to original position quickly, easily and without any extra effort).
- Drilling depth calibrated ruler, 60 mm drilling capacity.
- Drilling power tool holder with Ø43/38mm. Robust column with Ø40mm.
- Die cast base with guides for easy clamping of workpiece, and holes for installation of stand in any workbench.
- Precise and smooth drilling of round or flat workpieces.

Ref. STE99

**43/38
mm**

**60
mm**

**510
mm**

				STE99
	Ø Clamping mm	Drilling Depth mm	Height mm	€
STE99	43/38	60	510	66,74



DRILLS AND DRILL CHUCK ACCESSORIES

DRILL CHUCK KEYS



	DC		
	Min.-Max. mm	Ø mm	€
DC-10	1 - 10	6	4,43
DC-13	1 - 13	6	5,41
DC-16	1 - 16	8	6,73
DC-20	5 - 20	9	11,94



SDS-PLUS ADAPTER



	DC	
	Thread	€
DC -3/8	3/8 - 24 UNF	15,01
DC -1/2	1/2 - 20 UNF	15,01



1/4" HEX. ADAPTER



	DC-01		
	Shank	Thread	€
DC-01	1/4" Hex.	3/8 - 24 UNF	8,68

REDUCTION SLEEVES

DIN 2185



MORSE TAPER		CR	
EXT.	INT.	L1 mm	€
1	0	80	24,13
2	1	92	23,80
3	1	99	32,51
3	2	112	33,12
4	1	124	50,05
4	2	124	47,03
4	3	140	47,03

MORSE TAPER		CR	
EXT.	INT.	L1 mm	€
5	1	156	86,15
5	2	156	78,63
5	3	156	78,63
5	4	171	80,28
6	3	218	150,61
6	4	218	170,89
6	5	218	170,89

INCREASE SOCKET

DIN 2187



MORSE TAPER		CA		
EXT.	INT.	L1 mm	D1 mm	€
1	2	160	30	49,99
2	3	196	36	67,96
3	4	240	48	114,61
4	5	300	63	192,37
5	6	415	80	540,64

EXTENSION REDUCING SLEEVES

DIN 2187

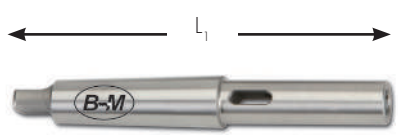

MORSE TAPER		CA	
EXT.	INT.	L1 mm	€
2	1	160	33,63
3	1	175	46,78
3	2	194	50,49
4	1	200	70,82
4	2	215	69,23
4	3	240	72,43
5	1	232	172,05

MORSE TAPER		CA	
EXT.	INT.	L1 mm	€
5	2	247	156,42
5	3	268	137,84
5	4	300	155,80
6	3	330	355,44
6	4	355	355,44
6	5	390	358,08

EXTENSION SLEEVES

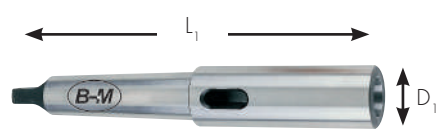

MORSE TAPER		CA		
EXT.	INT.	L1 mm	D1 mm	€
1	1	145	20	32,71
2	2	175	30	47,59
3	3	215	36	72,08
4	4	265	48	131,29
5	5	335	63	247,32
6	6	470	85	567,66

DRILLS AND DRILL CHUCKS ACCESSORIES

TAPER DRILL CHUCK ARBOR

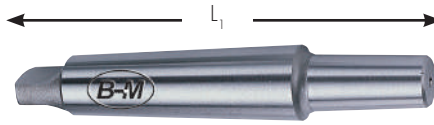

MT*	ARBOR	L1 mm	CM €
1	B10	86	14,33
1	B12	89	10,76
1	B16	99	10,76
1	B18	107	12,34
2	B10	105	17,13
2	B12	106	13,08
2	B16	112	13,08
2	B18	119	13,08
2	B22	130	25,78
3	B12	127	19,69
3	B16	134	15,93
3	B18	140	15,93

MT*	ARBOR	L1 mm	CM €
3	B22	147	26,82
3	B24	157	39,56
4	B16	158	23,96
4	B18	166	24,60
4	B22	176	44,24
4	B24	186	44,74
5	B16	193	86,77
5	B18	200	86,77
5	B22	208	90,51
5	B24	221	98,32
6	B22	240	184,89

HOLDING-PIN EXTRACTOR B16 AND B18 FOR DRILL CHUCK CONES



CMEXT
48,16 €

DRILL DRIFTS



DIN 317

Nº	USEFULL FOR MT	L1 mm	CE €
0	0	90	14,32
1	1 / 2	140	16,92
3	3	190	22,34
4	4	225	30,40
5	5 / 6	265	49,36



DIN 228

	MORSE TAPER	A	CMR €		MORSE TAPER	A	CMR €
CMR1-3/8	1	3/8-24h	21,14	CMR2-5/8	2	5/8-16h	21,14
CMR1-1/2	1	1/2-20h	21,14	CMR3-3/8	3	3/8-24h	28,60
CMR2-3/8	2	3/8-24h	21,14	CMR3-1/2	3	1/2-20h	28,60
CMR2-1/2	2	1/2-20h	21,14	CMR3-5/8	3	5/8-16h	28,60

ACCESSORIES

LATHE CENTER



	D1 mm	L1 mm	MT* INT.	CPC €	SOLID CARBIDE	CPC..MD €
CPCM1	12	80	1	15,52		
CPCM2	18	100	2	20,63	CPCM2-MD	59,31
CPCM3	24	125	3	32,06	CPCM3-MD	80,94
CPCM4	31	160	4	50,08	CPCM4-MD	98,72
CPCM5	44	200	5	70,76	CPCM5-MD	167,82
CPCM6	63	270	6	272,83		

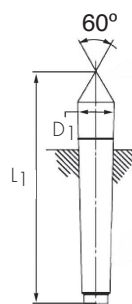

LIVE CENTER



	D1 mm	D2 mm	L1 mm	MT*	PGC €
PGCM1	34	18	120	1	148,56
PGCM2	50	21	148	2	165,69
PGCM3	60	24	185	3	222,75
PGCM4	63	30	220	4	264,00
PGCM5	75	44	260	5	381,56

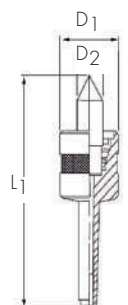

TAP HOLDERS

Ref. TC10

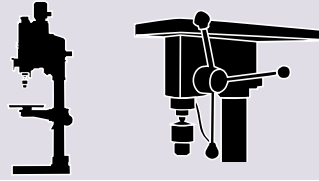
DIN
228B

- With longitudinal compensation in compression and traction
- Taper Shank

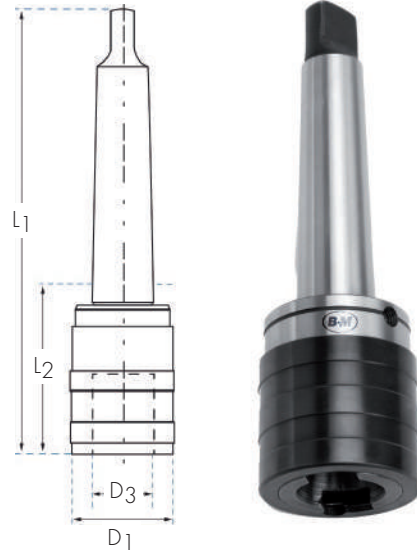

TC10						
	D1 mm	D3 mm	L1 mm	L2 mm	MORSE TAPER	€
TC10-19-CM2	36	19	122	47	2	316,35
TC10-19-CM3	36	19	141	47	3	404,19
TC10-31-CM3	53	31	165	71	3	520,11
TC10-31-CM4	53	31	189	72	4	579,55
TC10-48-CM4	78	48	222	105	4	876,75
TC10-48-CM5	78	48	255	106	5	936,19

TAP HOLDER WITHOUT CLUTCH

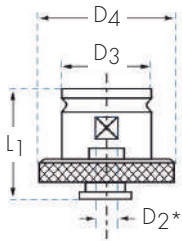

TC15					
	D2 mm	D3 mm	L1 mm	D4 mm	€
TC15-19-035	3,5	19	28	30	42,36
TC15-19-040	4,0	19	28	30	42,36
TC15-19-045	4,5	19	28	30	42,36
TC15-19-060	6,0	19	28	30	42,36
TC15-19-070	7,0	19	28	30	42,36
TC15-19-080	8,0	19	28	30	42,36
TC15-19-090	9,0	19	28	30	42,36
TC15-19-100	10,0	19	28	30	42,36
TC15-31-070	7,0	31	46	48	59,47
TC15-31-080	8,0	31	46	48	59,47
TC15-31-090	9,0	31	46	48	59,47
TC15-31-100	10,0	31	46	48	59,47
TC15-31-110	11,0	31	46	48	59,47
TC15-31-120	12,0	31	46	48	59,47
TC15-31-140	14,0	31	46	48	59,47
TC15-31-160	16,0	31	46	48	59,47
TC15-48-110	11,0	48	69	70	157,57
TC15-48-120	12,0	48	69	70	157,57
TC15-48-140	14,0	48	69	70	157,57
TC15-48-160	16,0	48	69	70	157,57
TC15-48-180	18,0	48	69	70	157,57
TC15-48-200	20,0	48	69	70	157,57
TC15-48-220	22,0	48	69	70	157,57
TC15-48-250	25,0	48	69	70	157,57
TC15-48-280	28,0	48	69	70	157,57

TAP HOLDER WITH CLUTCH

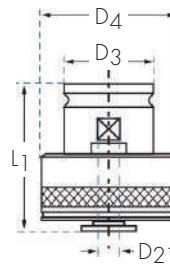

TC16					
	D2 mm	D3 mm	L1 mm	D4 mm	€
TC16-19-035	3,5	19	46	32	101,67
TC16-19-040	4,0	19	46	32	101,67
TC16-19-045	4,5	19	46	32	101,67
TC16-19-060	6,0	19	46	32	101,67
TC16-19-070	7,0	19	46	32	101,67
TC16-19-080	8,0	19	46	32	101,67
TC16-19-090	9,0	19	46	32	101,67
TC16-19-100	10,0	19	46	32	101,67
TC16-31-070	7,0	31	69	50	128,77
TC16-31-080	8,0	31	69	50	128,77
TC16-31-090	9,0	31	69	50	128,77
TC16-31-100	10,0	31	69	50	128,77
TC16-31-110	11,0	31	69	50	128,77
TC16-31-120	12,0	31	69	50	128,77
TC16-31-140	14,0	31	69	50	128,77
TC16-31-160	16,0	31	69	50	128,77
TC16-48-110	11,0	48	100	70	285,09
TC16-48-120	12,0	48	100	70	285,09
TC16-48-140	14,0	48	100	70	285,09
TC16-48-160	16,0	48	100	70	285,09
TC16-48-180	18,0	48	100	70	285,09
TC16-48-200	20,0	48	100	70	285,09
TC16-48-220	22,0	48	100	70	285,09
TC16-48-250	25,0	48	100	70	285,09
TC16-48-280	28,0	48	100	70	285,09

* D2: Ø of the shank of the tap

* To get information about the Ø of the shank of the tap please consult page 127.

TAPS SUITABLES FOR TAP HOLDER WITH/WITHOUT CLUTCH

D2 mm.								
3,5	4	4,5	6	7	8	9	10	11
M3x0,50R	M3,5x0,60R	M4x0,50R	M4,5x0,50R	M9x1,00D	M8x1,25R	M9x1,25R	M10x1,50R	M13x0,75D
M3x0,60R	M3,5x0,75R	M4x0,70R	M4,5x0,75R	M9x1,25D	M11x0,75D	M12x0,75D		M13x1,00D
M5x0,50D		M4x0,75R	M5x0,50R	M10x0,50D	M11x1,00D	M12x1,00D		M13x1,25D
M5x0,75D		M4x0,80R	M5x0,75R	M10x0,75D	M11x1,25D	M12x1,25D		M13x1,50D
M5x0,80D		M6x0,50D	M5x0,80R	M10x1,00D	M11x1,50D	M12x1,50D		M13x1,75D
M5x0,90D		M6x0,75D	M5x0,90R	M10x1,25D		M12x1,75D		M14x0,75D
		M6x1,00D	M5x1,00R	M10x1,50D				M14x1,00D
			M5,5x0,90R					M14x1,25D
			M6x0,50R					M14x1,50D
			M6x0,75R					M14x2,00D
			M6x1,00R					
			M6x1,25R					
			M8x0,50D					
			M8x0,75D					
			M8x1,00D					
			M8x1,25D					
			M8x1,50D					

D2 mm.							
12	14	16	18	20	22	25	28
M15x1,00D	M18x1,00D	M20x1,00D	M22x1,00D	M27x1,00D	M30x1,00D	M33x1,00D	M34x1,50D
M15x1,25D	M18x1,25D	M20x1,25D	M22x1,25D	M27x1,50D	M30x1,50D	M33x1,50D	M34x2,00D
M15x1,50D	M18x1,50D	M20x1,50D	M22x1,50D	M27x2,00D	M30x2,00D	M33x2,00D	M35x1,50D
M15x2,00D	M18x2,00D	M20x2,00D	M22x2,00D	M27x3,00D	M30x3,00D	M33x3,50D	M35x2,00D
M16x1,00D	M18x2,50D	M20x2,50D	M22x2,50D	M28x1,00D	M30x3,50D		M36x1,50D
M16x1,25D	M19x1,00D	M21x1,00D	M23x1,00D	M28x1,50D	M32x1,00D		M36x2,00D
M16x1,50D	M19x1,25D	M21x1,25D	M23x1,50D	M28x2,00D	M32x1,50D		M36x3,00D
M16x2,00D	M19x1,50D	M21x1,50D	M24x1,00D		M32x2,00D		M36x4,00D
M17x1,00D	M19x2,00D		M24x1,25D				M38x1,50D
M17x1,25D			M24x1,50D				M38x2,00D
M17x1,50D			M24x2,00D				
			M24x3,00D				
			M25x1,00D				
			M25x1,25D				
			M25x1,50D				
			M25x2,00D				
			M26x1,00D				
			M26x1,50D				
			M26x2,00D				

* D2: Ø of the shank of the tap
 * Chart is for taps DIN 371/374/DIN376
 * R: Reinforced
 * D: Straight

PRECISION COLLET

TYPE
ERDIN
6499-B $\alpha: 8^\circ \beta: 30^\circ$

Collets to be used in cutting tools with plain straight shank.

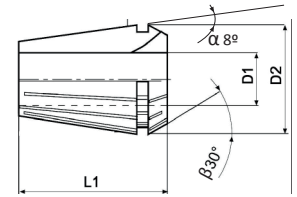

D2: 8,5 L1: 13,5



D2: 11,5 L1: 18



ER8

EXC 0,01	INDUSTRIAL		EXC 0,005	HIGH PRECISION	
	Capacity D1	€		Capacity D1	€
ER8-1	0,5-1,0	51,98	ER8-1MICRO	0,5-1,0	-
ER8-1,5	1,0-1,5	51,98	ER8-1,5MICRO	1,0-1,5	-
ER8-2	1,5-2,0	44,55	ER8-2MICRO	1,5-2,0	-
ER8-2,5	2,0-2,5	44,55	ER8-2,5MICRO	2,0-2,5	-
ER8-3	2,5-3,0	39,11	ER8-3MICRO	2,5-3,0	-
ER8-3,5	3,0-3,5	39,11	ER8-3,5MICRO	3,0-3,5	-
ER8-4	3,5-4,0	39,11	ER8-4MICRO	3,5-4,0	-
ER8-4,5	4,0-4,5	39,11	ER8-4,5MICRO	4,0-4,5	-
ER8-5	4,5-5,0	39,11	ER8-5MICRO	4,5-5,0	-

ER11

EXC 0,01	INDUSTRIAL		EXC 0,005	HIGH PRECISION	
	Capacity D1	€		Capacity D1	€
ER11-1	0,5-1,0	49,50	ER11-1MICRO	0,5-1,0	-
ER11-1,5	1,0-1,5	49,50	ER11-1,5MICRO	1,0-1,5	-
ER11-2	1,5-2,0	42,44	ER11-2MICRO	1,5-2,0	-
ER11-2,5	2,0-2,5	42,44	ER11-2,5MICRO	2,0-2,5	-
ER11-3	2,5-3,0	37,26	ER11-3MICRO	2,5-3,0	-
ER11-3,5	3,0-3,5	37,26	ER11-3,5MICRO	3,0-3,5	53,33
ER11-4	3,5-4,0	37,26	ER11-4MICRO	3,5-4,0	53,33
ER11-4,5	4,0-4,5	37,26	ER11-4,5MICRO	4,0-4,5	53,33
ER11-5	4,5-5,0	37,26	ER11-5MICRO	4,5-5,0	53,33
ER11-5,5	5,0-5,5	37,26	ER11-5,5MICRO	5,0-5,5	53,33
ER11-6	5,5-6,0	37,26	ER11-6MICRO	5,5-6,0	53,33
ER11-6,5	6,0-6,6	37,26	ER11-6,5MICRO	6,0-6,6	53,33
ER11-7	6,5-7,0	37,26	ER11-7MICRO	6,5-7,0	53,33

D2: 17 L1: 27,5



D2: 26 L1: 34

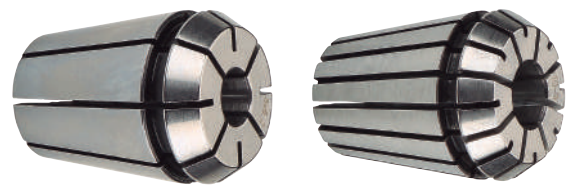

ER16

EXC 0,01	INDUSTRIAL		EXC 0,005	HIGH PRECISION	
	Capacity D1	€		Capacity D1	€
ER16-1	0,5-1,0	44,35	ER16-1MICRO	0,5-1,0	-
ER16-2	1,0-2,0	39,93	ER16-2MICRO	1,0-2,0	-
ER16-3	2,0-3,0	35,93	ER16-3MICRO	2,0-3,0	-
ER16-4	3,0-4,0	35,93	ER16-4MICRO	3,0-4,0	47,49
ER16-5	4,0-5,0	35,93	ER16-5MICRO	4,0-5,0	47,49
ER16-6	5,0-6,0	35,93	ER16-6MICRO	5,0-6,0	47,49
ER16-7	6,0-7,0	35,93	ER16-7MICRO	6,0-7,0	47,49
ER16-8	7,0-8,0	35,93	ER16-8MICRO	7,0-8,0	47,49
ER16-9	8,0-9,0	35,93	ER16-9MICRO	8,0-9,0	47,49
ER16-10	9,0-10,0	35,93	ER16-10MICRO	9,0-10,0	47,49

ER25

EXC 0,01	INDUSTRIAL		EXC 0,005	HIGH PRECISION	
	Capacity D1	€		Capacity D1	€
ER25-2	1,0-2,0	41,14	ER25-2MICRO	1,0-2,0	-
ER25-3	2,0-3,0	41,14	ER25-3MICRO	2,0-3,0	-
ER25-4	3,0-4,0	41,14	ER25-4MICRO	3,0-4,0	51,15
ER25-5	4,0-5,0	41,14	ER25-5MICRO	4,0-5,0	51,15
ER25-6	5,0-6,0	41,14	ER25-6MICRO	5,0-6,0	51,15
ER25-7	6,0-7,0	41,14	ER25-7MICRO	6,0-7,0	51,15
ER25-8	7,0-8,0	41,14	ER25-8MICRO	7,0-8,0	51,15
ER25-9	8,0-9,0	41,14	ER25-9MICRO	8,0-9,0	51,15
ER25-10	9,0-10,0	41,14	ER25-10MICRO	9,0-10,0	51,15
ER25-11	10,0-11,0	41,14	ER25-11MICRO	10,0-11,0	51,15
ER25-12	11,0-12,0	41,14	ER25-12MICRO	11,0-12,0	51,15
ER25-13	12,0-13,0	41,14	ER25-13MICRO	12,0-13,0	51,15
ER25-14	13,0-14,0	41,14	ER25-14MICRO	13,0-14,0	51,15
ER25-15	14,0-15,0	41,14	ER25-15MICRO	14,0-15,0	51,15
ER25-16	15,0-16,0	41,14	ER25-16MICRO	15,0-16,0	51,15

PRECISION COLLET

**TYPE
ER**

**DIN
6499-B**

$\alpha: 8^\circ \beta: 30^\circ$

Collets to be used in cutting tools with plain straight shank.

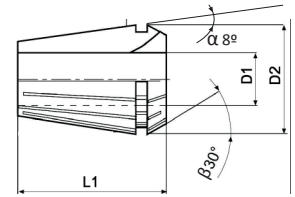

D2: 33 L1: 40

D2: 41 L1: 46

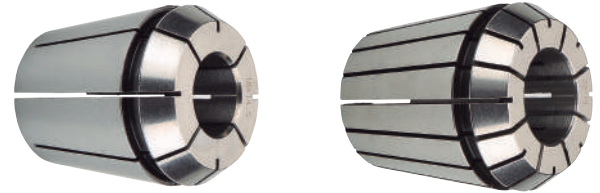
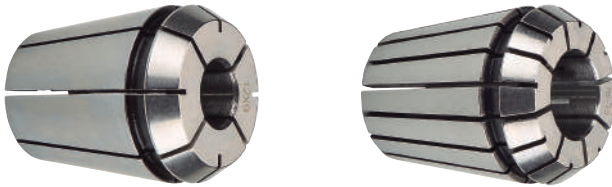

ER32

EXC 0,01	INDUSTRIAL		EXC 0,005	HIGH PRECISION	
	Capacity D1	€		Capacity D1	€
ER32-3	2,0-3,0	39,10	ER32-3MICRO	2,0-3,0	-
ER32-4	3,0-4,0	39,10	ER32-4MICRO	3,0-4,0	53,41
ER32-5	4,0-5,0	39,10	ER32-5MICRO	4,0-5,0	53,41
ER32-6	5,0-6,0	39,10	ER32-6MICRO	5,0-6,0	53,41
ER32-7	6,0-7,0	39,10	ER32-7MICRO	6,0-7,0	53,41
ER32-8	7,0-8,0	39,10	ER32-8MICRO	7,0-8,0	53,41
ER32-9	8,0-9,0	39,10	ER32-9MICRO	8,0-9,0	53,41
ER32-10	9,0-10,0	39,10	ER32-10MICRO	9,0-10,0	53,41
ER32-11	10,0-11,0	39,10	ER32-11MICRO	10,0-11,0	53,41
ER32-12	11,0-12,0	39,10	ER32-12MICRO	11,0-12,0	53,41
ER32-13	12,0-13,0	39,10	ER32-13MICRO	12,0-13,0	53,41
ER32-14	13,0-14,0	39,10	ER32-14MICRO	13,0-14,0	53,41
ER32-15	14,0-15,0	39,10	ER32-15MICRO	14,0-15,0	53,41
ER32-16	15,0-16,0	39,10	ER32-16MICRO	15,0-16,0	53,41
ER32-17	16,0-17,0	39,10	ER32-17MICRO	16,0-17,0	53,41
ER32-18	17,0-18,0	39,10	ER32-18MICRO	17,0-18,0	53,41
ER32-19	18,0-19,0	39,10	ER32-19MICRO	18,0-19,0	53,41
ER32-20	19,0-20,0	39,10	ER32-20MICRO	19,0-20,0	53,41

ER40

EXC 0,01	INDUSTRIAL		EXC 0,005	HIGH PRECISION	
	Capacity D1	€		Capacity D1	€
ER40-3	2,0-3,0	49,69	ER40-3MICRO	2,0-3,0	-
ER40-4	3,0-4,0	49,69	ER40-4MICRO	3,0-4,0	63,55
ER40-5	4,0-5,0	49,69	ER40-5MICRO	4,0-5,0	63,55
ER40-6	5,0-6,0	49,69	ER40-6MICRO	5,0-6,0	63,55
ER40-7	6,0-7,0	49,69	ER40-7MICRO	6,0-7,0	63,55
ER40-8	7,0-8,0	49,69	ER40-8MICRO	7,0-8,0	63,55
ER40-9	8,0-9,0	49,69	ER40-9MICRO	8,0-9,0	63,55
ER40-10	9,0-10,0	49,69	ER40-10MICRO	9,0-10,0	63,55
ER40-11	10,0-11,0	49,69	ER40-11MICRO	10,0-11,0	63,55
ER40-12	11,0-12,0	49,69	ER40-12MICRO	11,0-12,0	63,55
ER40-13	12,0-13,0	49,69	ER40-13MICRO	12,0-13,0	63,55
ER40-14	13,0-14,0	49,69	ER40-14MICRO	13,0-14,0	63,55
ER40-15	14,0-15,0	49,69	ER40-15MICRO	14,0-15,0	63,55
ER40-16	15,0-16,0	49,69	ER40-16MICRO	15,0-16,0	63,55
ER40-17	16,0-17,0	49,69	ER40-17MICRO	16,0-17,0	63,55
ER40-18	17,0-18,0	49,69	ER40-18MICRO	17,0-18,0	63,55
ER40-19	18,0-19,0	49,69	ER40-19MICRO	18,0-19,0	63,55
ER40-20	19,0-20,0	49,69	ER40-20MICRO	19,0-20,0	63,55
ER40-21	20,0-21,0	49,69	ER40-21MICRO	20,0-21,0	63,55
ER40-22	21,0-22,0	49,69	ER40-22MICRO	21,0-22,0	63,55
ER40-23	22,0-23,0	49,69	ER40-23MICRO	22,0-23,0	63,55
ER40-24	23,0-24,0	49,69	ER40-24MICRO	23,0-24,0	63,55
ER40-25	24,0-25,0	49,69	ER40-25MICRO	24,0-25,0	63,55
ER40-26	25,0-26,0	49,69	ER40-26MICRO	25,0-26,0	63,55

PROFESSIONAL BLUE-MASTER SHARPENER



*Includes case and spare grinding wheel



Ref. AFB10

Forget about the electrical failures of other sharpeners
Anti short circuit devices

AFB10

SHARPENING
RANGE:Ø
3-13POINT
ANGLE:

118°

SHARPENING
TYPES:RESHARPENING
OF DRILLS:

HSS

HSSCo

SOLID
CARBIDE

TIN

CARBIDE
TIPPED

283,04 €

SHARP YOUR DRILLS IN 4 STEPS

1
Place and adjust the
drill in the chuck2
Sharpen the drill3
Check the normal sharpening4
Split Point sharpening

CHUCK

PAFB10
33,25 €

GRINDING WHEEL

MAFB10
34,81 €

AFB10 SUPPORT

SOPAFB10
31,16 €

DRILL DOCTOR SHARPENERS

750X
High Precision



AFB1

SHARPENING RANGE:	Ø 2,5-19			
POINT ANGLE:	118°	135°		
SHARPENING TYPES:				
RESHARPENING OF DRILLS:	HSS	HSSCo	SOLID CARBIDE	TiN CARBIDE TIPPED

*Includes pouch

520,19 €

500X
Professional Sharpening



AFB2

SHARPENING RANGE:	Ø 2,5-13			
POINT ANGLE:	118°	135°		
SHARPENING TYPES:				
RESHARPENING OF DRILLS:	HSS	HSSCo	SOLID CARBIDE	TiN CARBIDE TIPPED

436,95 €

XP
Practical & Economic



AFB3

SHARPENING RANGE:	Ø 2,5-13			
POINT ANGLE:	118°			
SHARPENING TYPES:				
RESHARPENING OF DRILLS:	HSS	HSSCo	SOLID CARBIDE	TiN CARBIDE TIPPED

210,57 €

ACCESSORIES FOR SHARPENERS

DRILL SHARPENER CHUCKS



For 750X

AFB1PB

78,72 €

For
Left hand drill

AFB2PBI

78,74 €

COARSE GRINDSTONE FOR 750X & 500X SHARPENER



AFBT

73,14 €

STANDARD GRINDSTONE FOR 750X & 500X SHARPENER



AFBR

73,14 €

SPARE SCREW FOR 750X & 500X



AFBTLL

8,63 €

AFB10 SUPPORT



SOPAFB10

31,16 €